

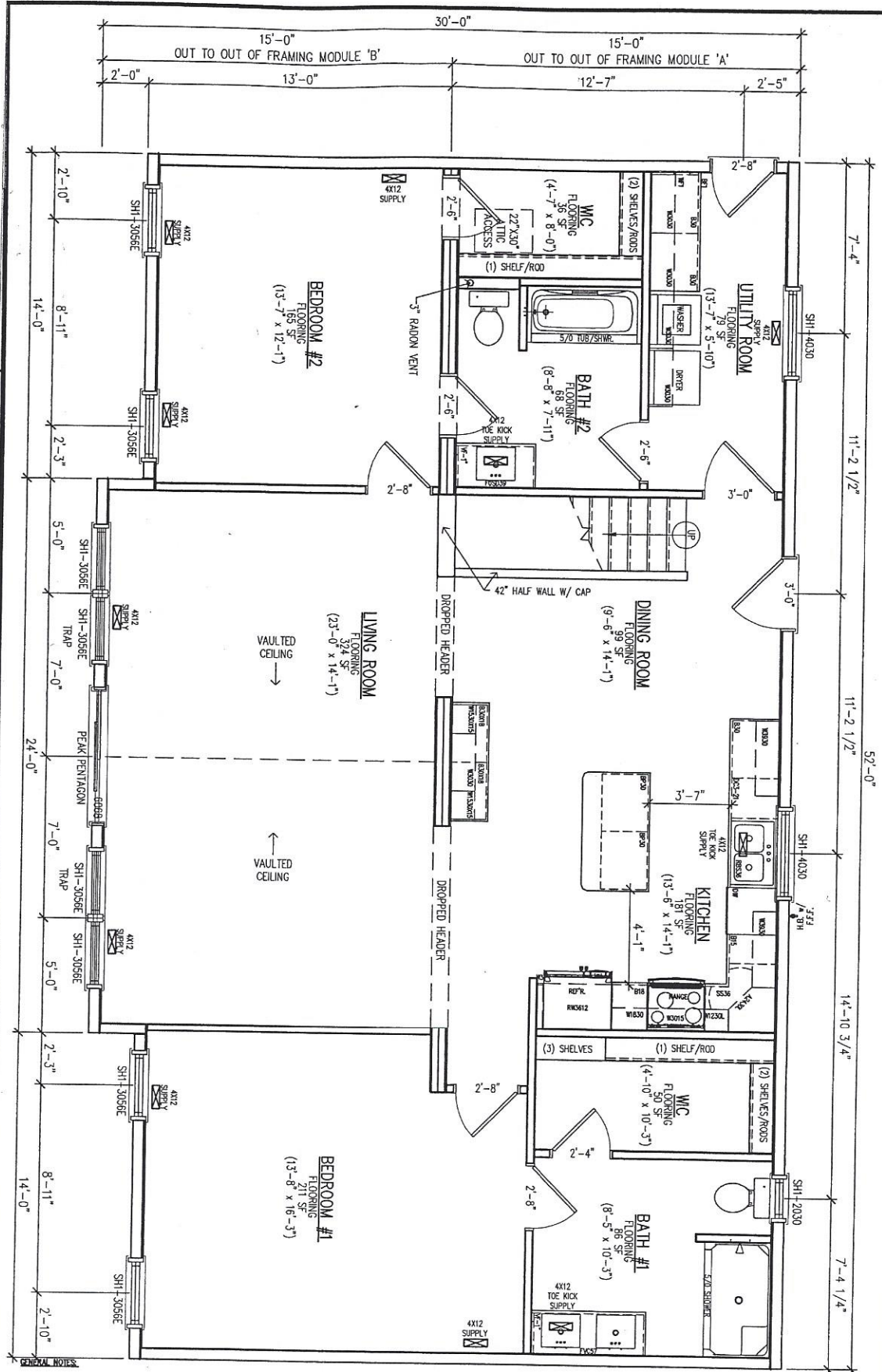

MAIN LEVEL FLOOR PLAN



NSXXXX	DEALER: NOTHSTAR HOMES
DATE: 07/16/19	CUSTOMER: GLENWOOD MODEL
REV: X BY: X	DATE: X
SCALE: 1/4" = 1'-0"	PAGE: A1.1

**GENERAL NOTES:**  
 WHOLE HOUSE AIR EXCHANGE MECH. SYSTEM TO BE INSTALLED ON-SITE - SEE R303.12 MECHANICAL VENTILATION  
 CLIMATE ZONE 7 - 0.35 U-FACTOR, R-50 CEILING, R-21 WALL BATTS  
 CLASS 3 VAPOR RETARDANT USED (LATEX PRIMER) - SEE R702.7.2 MATERIAL VAPOR RETARDANT CLASS  
 TRUSSES ARE DESIGNED AND SEALED FOR MINNESOTA  
 ALL RECEPTACLES ARE TO BE TAMPER PROOF  
 WASHER APPLIANCE RECEPTACLE MUST BE READILY ACCESSIBLE  
 PLAN CAN BE MIRROR IMAGED

EVERY CIRCUIT IN HABITABLE PORTIONS OF THE DWELLING MUST BE PROTECTED BY A COMBINATION TYPE AFCI DEVICE INCLUDING KITCHEN & LAUNDRY AREAS  
 SERVICE PANEL - SIEMENS LOADCENTER 200 AMP PANEL WITH (40) SPACES, NEMA 1, 120/240 VAC  
 RECESSED LUMINAIRES SHALL BE SEALED WITH A GASKET OR CAULK BETWEEN CONDITIONED AND UNCONDITIONED SPACE  
 REF. 2015 IRC (R404.4.4) LED DOWN LIGHTS LOCATED IN NET LOCATIONS ARE TO BE RATED ACCORDINGLY  
 BATH VENT/LIGHT COMBINATION UNIT - 2.5 SONES, 70 CFM/PCM  
 WATER LINE ON-SITE BY OTHERS (GRAB IF BY NOTHSTAR)

MINIMUM OF TWO (2) 20-AMP SMALL APPLIANCE BRANCH CIRCUITS SHALL BE INSTALLED TO SUPPLY RECEPTACLE OUTLETS IN KITCHEN- KITCHEN COUNTER OUTLETS TO BE ON ALTERNATING 20 AMP CIRCUITS  
 ALL SMOKE AND SMOKE/CARBON ALARMS ARE TO BE INTERCONNECTED  
 SEAL CRAWL SPACE ACCESS AND PROVIDE A GFI PROTECTED TYPE "B" LIGHT FIXTURE AND A GFI PROTECTED DUPLEX RECEPTACLE  
 ATTIC ACCESS TO BE SEALED AND FACTORY TO INSTALL SWITCHED LUMINAIRE AND DUPLEX RECEPTACLE IN ATTIC AT OR NEAR POINT OF ACCESS  
 MINIMUM 24" DIA. X 36" HIGH CLEARANCE REQUIRED AROUND RADON PIPE IN ATTIC  
 PROPER AIR GAP CONNECTION REQUIRED TO THE DISHWASHER IN ACCORDANCE WITH 807.3 OF THE 2015 UPC & 414.3 OF THE 2015 IAPL PLUMBING CODE